



8' X 10' SET UP INSTRUCTIONS

© 2016 Grosh Scenic Rentals

CONTENTS:

One Rolling duffel bag



One Pop-Up frame with backdrop

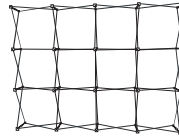

Two metal stabilized feet

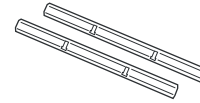

One shipping case



- 1** Remove unit from hard case and rolling bag. The Backdrop Skin is already attached to the frame.

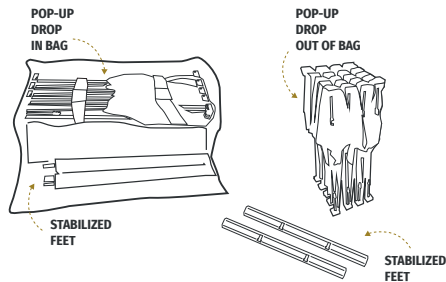

- 2** On a clean floor, stretch frame outward completely so that the locking arms are as close together as possible. Make sure webbing is not wrapped around the purple locking arms.

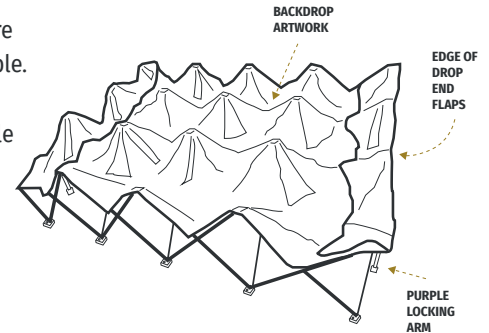

- 3** Once frame is stretched, carefully align all purple locking arms on the outer perimeter of the frame together and click into place. After outer perimeter locking arms are completed, slowly walk the frame upright and click the six remaining locking arms to complete the frame set up.

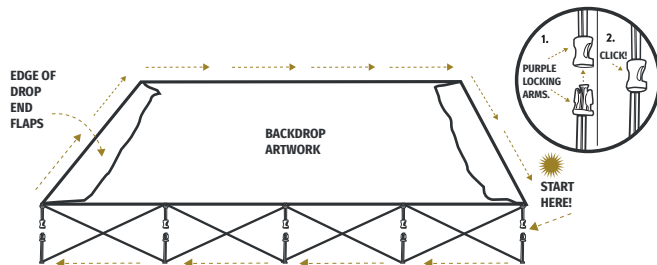

TIP! Make sure to click locking arms straight to avoid breaking.

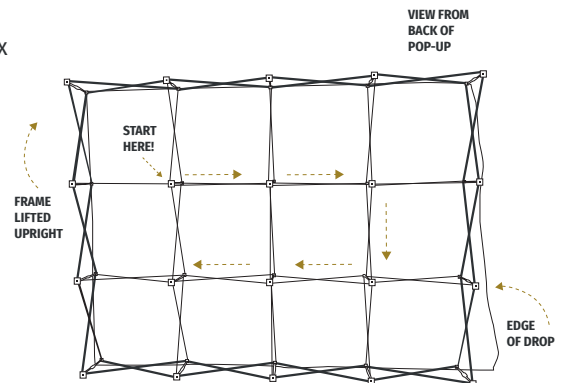

- 4** Attach feet by sliding the foot over both hubs on the bottom of the frame at the same time. Slide foot from left to right. Repeat for other foot.

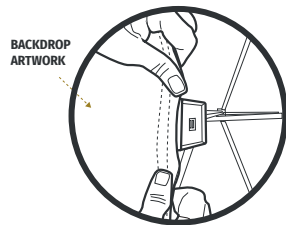

- 5** Attach feet by sliding the foot over both hubs on the bottom of the frame at the same time. Slide foot from left to right. Repeat for other foot.

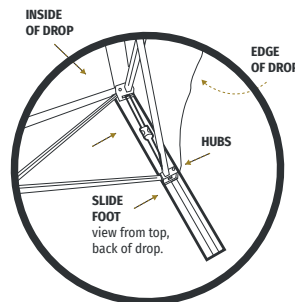
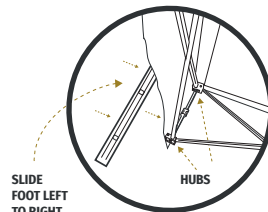

- 6** POP! Raise and Set up Pop-Up drop in desired and safe location.



TO COLLAPSE

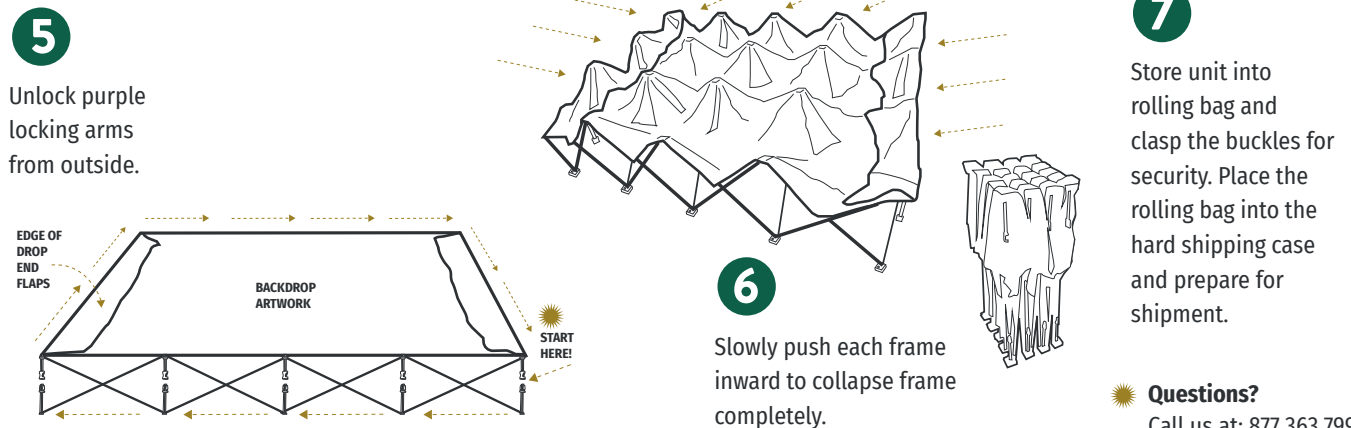
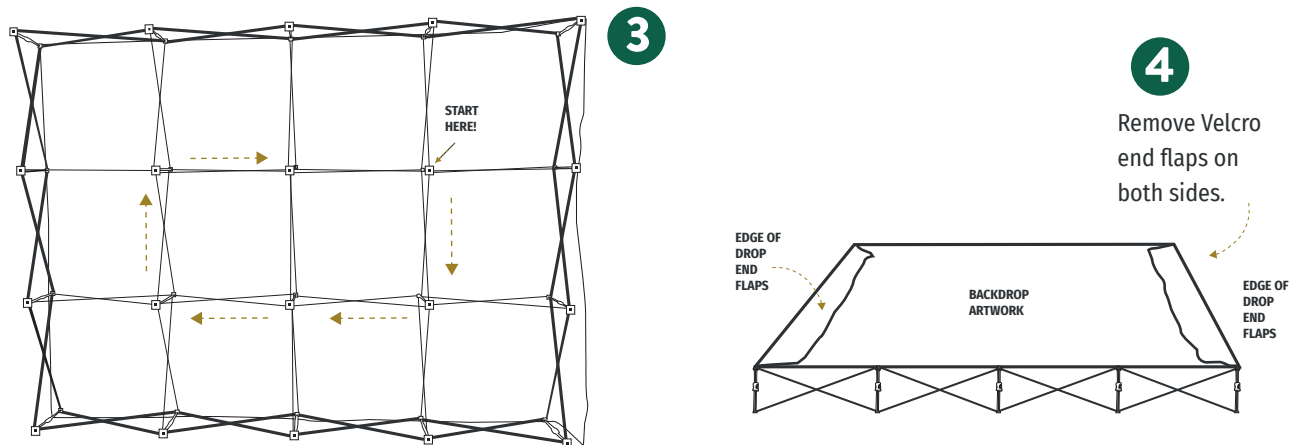
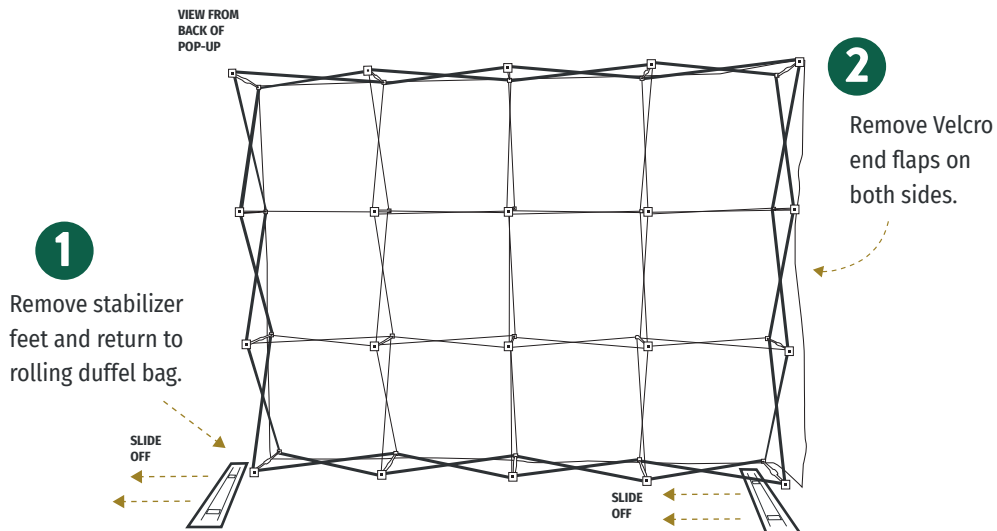

Questions?
Call us at: 877.363.7998
WWW.GROSH.COM